

Digital Angle Torque Wrench OPERATION MANUAL

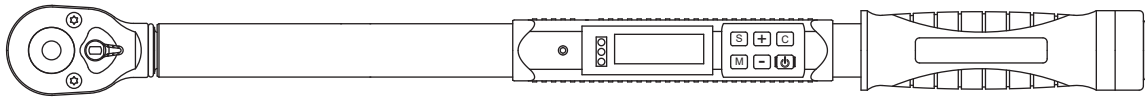

BEFORE STARTING

1. Before operating this torque wrench study carefully these instructions.
2. Main usage & application digital torque wrench is different from general torque wrench, it has strong operation function including torque setting, mode setting, data storage, data clear and data output.
It is easy to operate, it reduce the requirements for the operator by install the digital display.
It is widely used for the automotive industry, machinery industry, such as bolt fastening and control.
3. Over-torquing(109% of Max. Torque range)could cause breakage or lose of accuracy.
4. Keep this digital torque wrench away from magnets. If the wrench gets wet, wipe it with a dry towel soon.
The salt in seawater can damage the wrench.
5. Do not apply excessive force to the LCD screen .
6. The plastic body is not affected by petroleum products but may be damaged by some industrial solvents.
Clean it by clean cloth soaked in mineral spirits or denatured alcohol. Never immerse this wrench or any part of it in any liquid.

PANEL

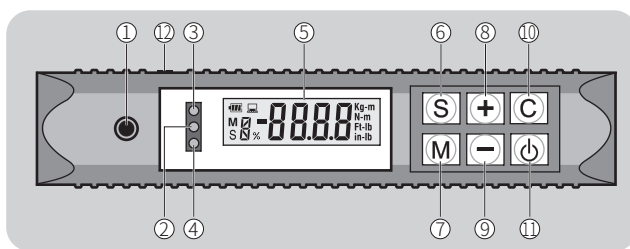

- 1 Buzzer
- 2 LED indicator (Green)
- 3 LED indicator (Red)
- 4 LED indicator (Yellow)
- 5 LCD panel
- 6 Set
- 7 Memo
- 8 Up / Angle Range Setting
- 9 Down
- 10 Cancel
- 11 Power
- 12 RS-232 Data out



- Battery
- Communication
- M** Memo
- S** Setting
- Tolerance
- Direction
- Values
- Kg-m** Units
- N-m** Units
- Ft-lb** Units
- in-lb** Units

CONTENTS

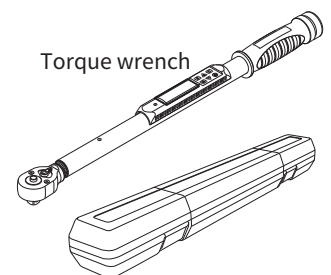

Supplied in a plastic box.

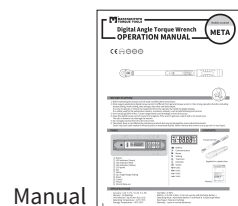

Manual

SPECIFICATIONS

- Accuracy : C.W. $\pm 1\%$ / C.C.W. $\pm 1.5\%$
- Memory : 50 Readings
- Unit Selection : kg-m, Nm, ft.lb, in.lb
- Operating Temperature : $-10^{\circ}\text{C}\sim 55^{\circ}\text{C}$
- Storage Temperature : $-40^{\circ}\text{C}\sim 85^{\circ}\text{C}$
- Humidity : 0~90%
- Battery : 1.5V UM-3 (AA) x 3 (Do not use low self-discharge battery)
- Operating Mode : Auto Reset Mode & Track Mode & Torque Angle Mode (See Page-2 Tolerance Setting)
- Warranty : 1 year in normal statement.

BATTERY INSTALLATION & POWER

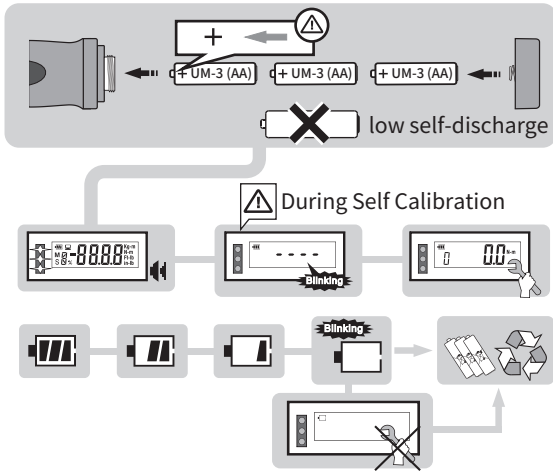

ON & OFF

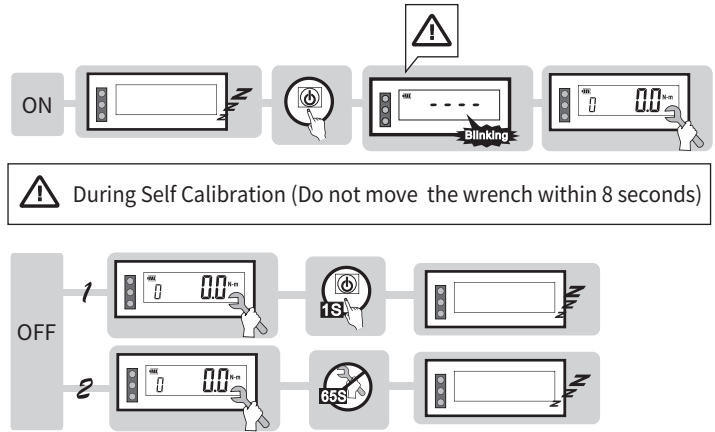

BATTERY MAINTENANCE

1. Please take the battery out if you do not use wrench for a long time .
2. Do not mix battery types or combine used batteries with new ones.
3. Sweat,oil and so on can prevent a battery's terminal from making electrical contact.
To avoid this, wipe both terminals before loading a battery .
4. Dispose of batteries in a designed disposal area. Do not throw batteries into a fire.

EDIT PRE-SET VALUE (Example : META-200N)

Select

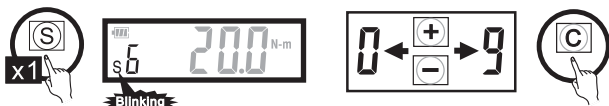

Track Mode

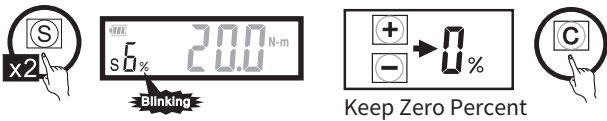

Unit Select

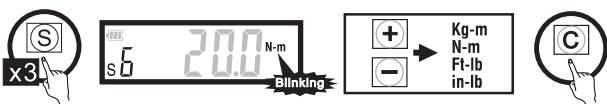

Auto Reset Mode

(Auto reset 2 seconds)

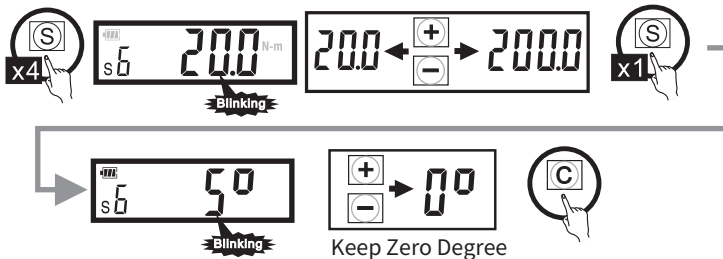

Torque Angle Mode

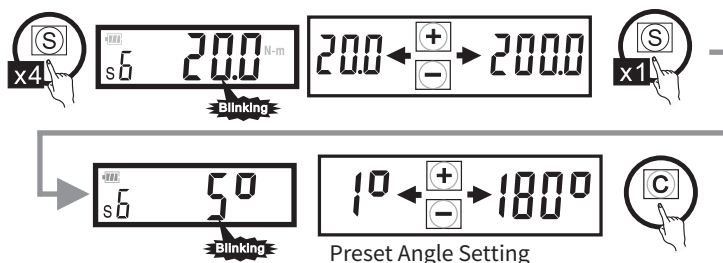

Angle Range Setting

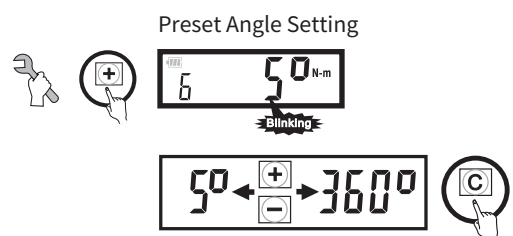

STATUS ICON DESCRIPTION

Notice	Idle 120 Sec.
Operation mode	Press the Button
Press the Button 1 Sec.	Press the Button 2 times
LCD Blinking	Beep sound
LED	Power OFF

RESET

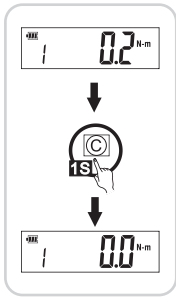

DIRECTION

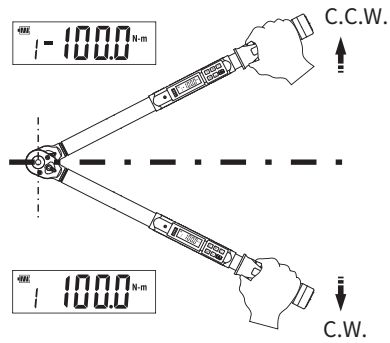

LIGHT

Red
Green
Yellow

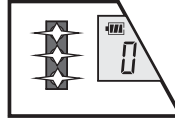

	Auto reset mode	Torque angle mode
Red LED	Over the pre-set deviating range	Over the pre-set angle (Allowable angle error)
Green LED	Within the pre-set deviating range	Equal the pre-set angle, Lower or equal the allowable angle error
Yellow LED	Lower then the pre-set deviating range	Lower than the pre-set angle

PRECAUTIONS

Insert square drive securely to the fitting or socket.

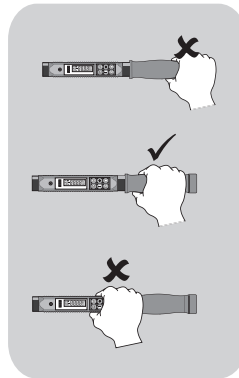
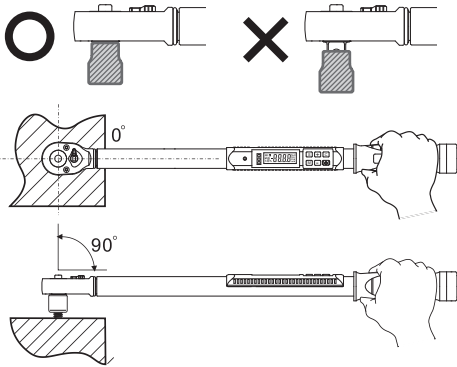

POSITION

Position of ratchet lever for clockwise/counter clockwise tightening.

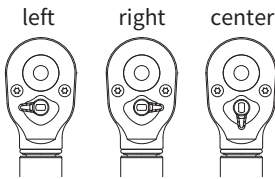

Choose a qualified socket

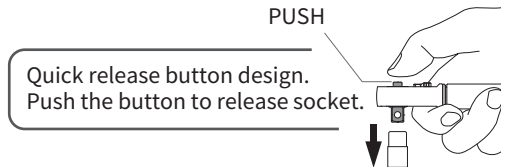

RS-232 CONNECTION

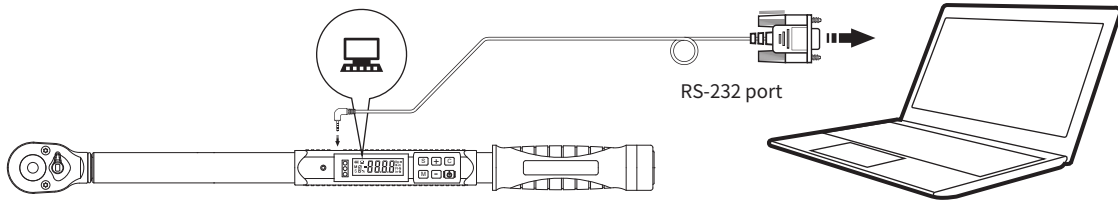

50 SETS OF HISTORICAL TORQUE VALUES

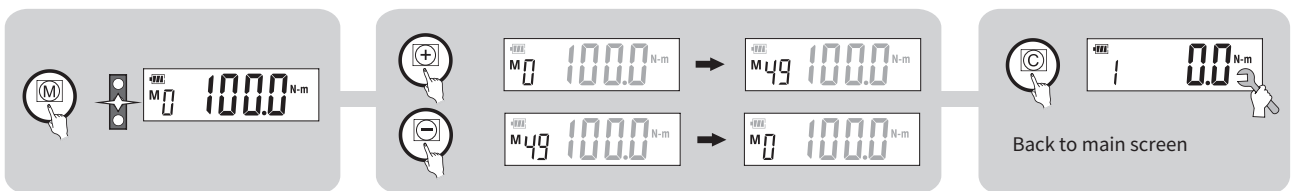

MEMORY BLOCK

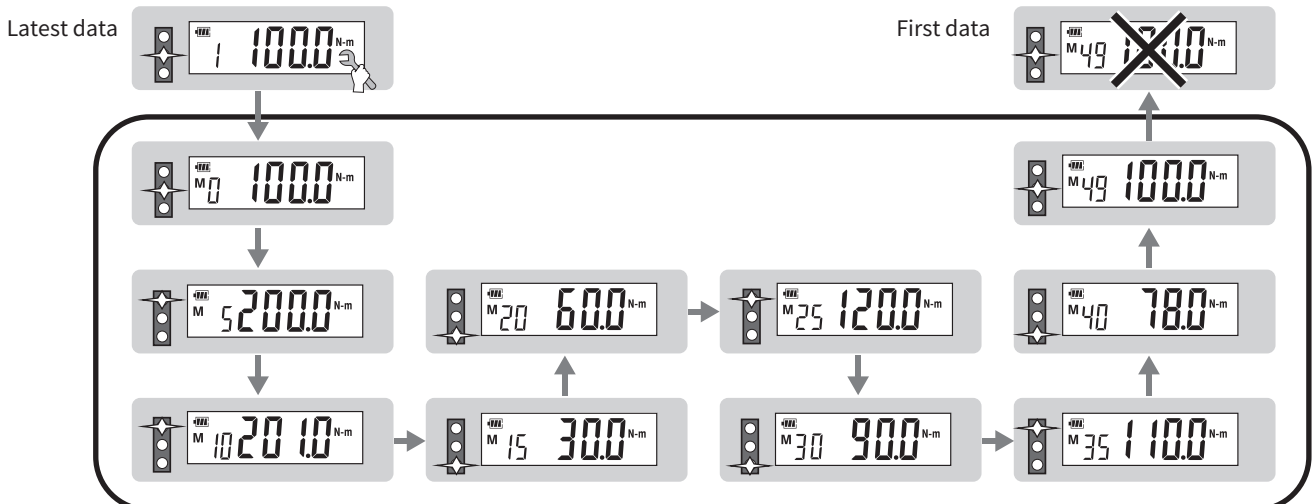

AUTO RESET MODE

Tolerance : 1%~9%
 Ex. : 100Nm±5%
 Angle=0°

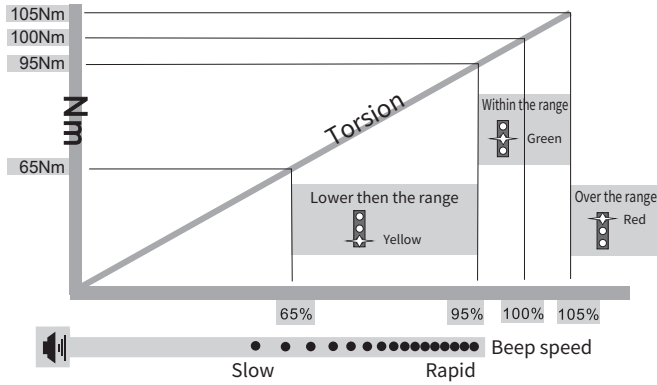

TRACK MODE

Tolerance : 0%

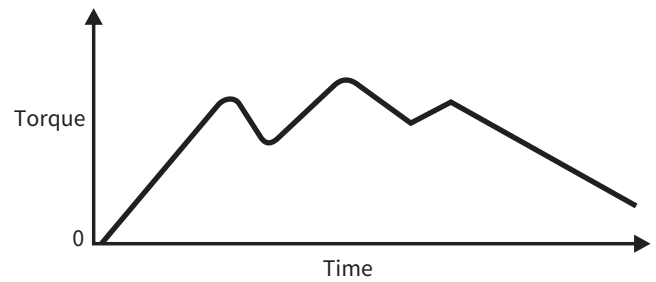

OPERATION EXAMPLE

Example :
 Set number : 6
 Pre-set Torque : 20 Nm
 Pre-set Angle : 35°
 Angle Range Setting : 38°

Torque Angle Mode

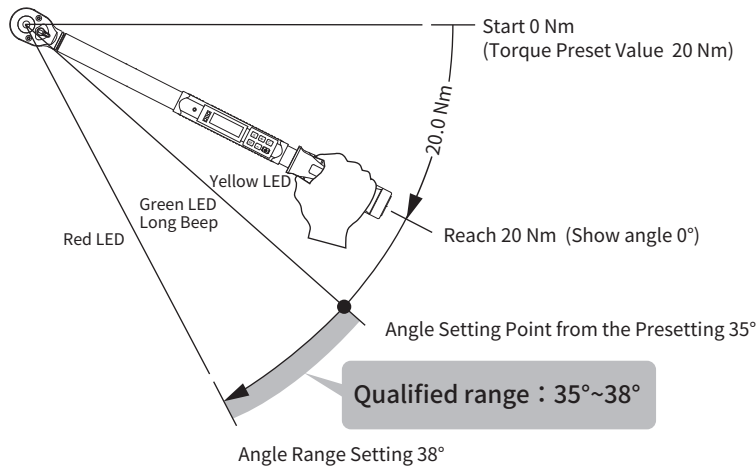

MAINTENANCE AND STORAGE

1. Clean this tool by wiping with a clean cloth after operation and storage in a dry environment. Do not dip any type of liquid in this tool. This may damage the internal of this tool.
2. This tool should be recalibrated a period of 1 years, or 5,000 cycles, whichever occurs first. To contact with local vendor or an authorized repair center for supporting.

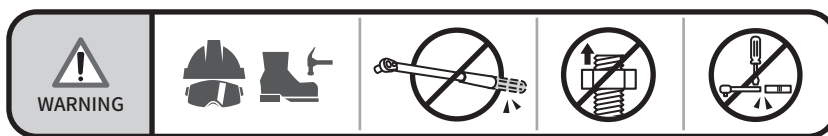
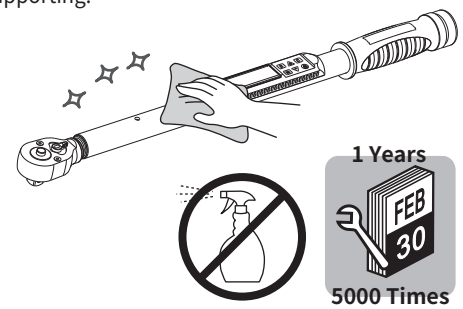

DIMENSIONS

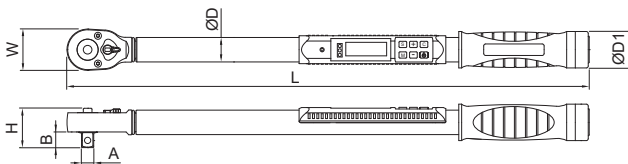

ITEM NO.	Ø A	Range	W	H	B	L	ØD	ØD1	KG
META-30N	1/4"	3-30 Nm	28.5	21.7	7.3	360	25.5	38.0	0.75
	3/8"			26.8	11.0				
META-60N	3/8"	6-60 Nm	28.5	26.8	11.0	360	25.5	38.0	0.76
META-100N	3/8"	10-100 Nm	35.6	35.1	11.0	440	25.6	37.3	0.95
META-100NS	1/2"	10-100 Nm	35.6	35.1	15.7	440	25.6	37.3	1.06
META-200N	1/2"	20-200 Nm	46.0	40.0	15.7	524	25.6	37.3	1.35
META-350N	1/2"	35-350 Nm	46.0	40.0	15.7	650	25.6	37.3	1.90

Unit : mm

Version 02

JUN. 2020



MATATAKITOYO
TORQUE TOOLS
 E-mail: matatakitoyo@gmail.com
 www.matatakitoyo.com

Manufacturer
MATATAKITOYO TOOL CO., LTD.
 No. 63, Ln. 493, Sec. 3, Zhongshan Rd., Tanzi Dist.,
 Taichung City 42754, Taiwan
 TEL : 886-4-2533 5893

Made in Taiwan